

MODEL 211.0 with CODE (860) TV tuner

- 1 Adapter cable
 2 Digital TV tuner
 3 Antenna wiring harness
 4 Remote control
 A2/42 TV tuner

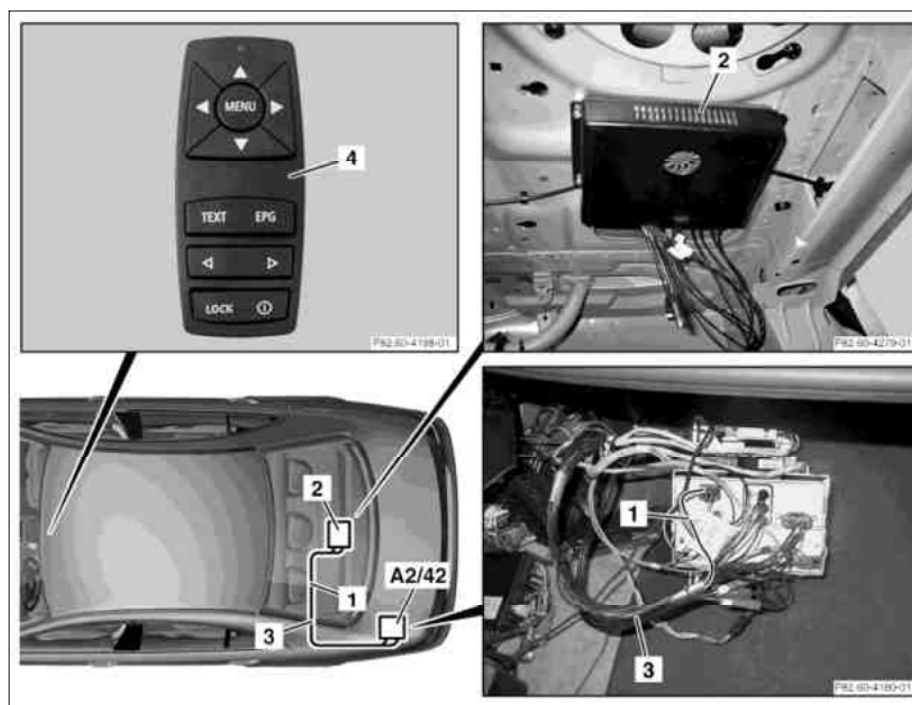

P82.60-4278-06

	Remove		
1 AR	Disconnect battery ground cable		AR54.10-P-0003T
2	Connect no load current retention unit	Quiescent current retention unit CMP 12.2.	*WH58.30-Z-1005-09A
3	Remove left luggage compartment trim		
4	Remove TV tuner		
	Install		
5	Retrofit digital TV tuner control unit	Riveter.	AZ82.60-P-0007-01T *WH58.30-Z-1010-29A
6	Retrofit TV tuner wiring harness		AN82.60-P-0001-03T
7	Carry out start-up and function test		AZ82.61-P-0001-04MM
8	Install remaining parts onto vehicle		

Commercially available tools (see Workshop Equipment Manual)

Number	Designation	Make (e. g.)	Order number
WH58.30-Z-1005-09A	Quiescent current retention unit CMP 12.2	Hans Zeheter	
WH58.30-Z-1010-29A	Manual riveting pliers	Alfred Honsel Nieten- u. Metallwarenfabrik GmbH & Co. Westtcker StraÙe 46 - 52 58730 Fröndenber Postfach 1262 / 1263 58718 Fröndenber Telephone: +49-2373- 755-0 Fax: +49-2373-755-183	VNG 255

Parts ordering notes

Part no.	Designation	Quantity
B6 782 64 41	Digital TV tuner parts kit	1
B6 782 64 54	Antenna housing kit	1